



1D Imager  
Barcode Scanner

# SOCKETSCAN® S730

## Ergonomic and Elegant

The SocketScan S730 laser 1D barcode scanner with Bluetooth wireless technology is ergonomic and comfortable to use for extended periods of time. The long-lasting battery withstands your entire work day while the scanner's laser scans hard-to-reach places, meeting various jobs' demands. It offers rapid scanning ability for moderate to rigorous scanning applications. It enables easy scanning of barcodes on high shelves or other unreachable areas. With intuitive light icons to keep users informed on its connection and power status, this scanner is ideal for scanning long distances through glass/plastic, in bright sunlight, on curved reflective surfaces or other sensitive lighting conditions. Compatible with all applications in previous Socket Mobile barcode scanners, without any software changes.

Use our Companion App for easy set up and configuration.



Certified by Apple® for iOS devices (iPad®, iPhone®, iPod Touch®) and compatible with Android and Windows®.

## Features

- **Bluetooth Wireless Technology** - Connects easily to a wide range of Bluetooth enabled smartphones, tablets, notebooks and desktop computers
- **Certified by Apple® for iOS devices** - Guaranteed Compatibility - With our SDK integrated in over 700+ applications, Socket Mobile scanners are one of the most natively integrated scanners available today. Socket Mobile Scanners are also 100% compatible with any application out-of-the-box in HID (keyboard emulation) mode.
- **Compatible with all Android and Windows devices and applications** - High Performance Class 2 laser, ideal for moderate to rigorous scanning applications (scans thousands of barcodes per day)
- **Flexible** - Effectively scans barcodes in sensitive lighting conditions, including through glass/plastic, in bright sunlight, in dark environments, or on curved/reflective surfaces
- **Long Read Range** - Up to 45" (1.1m) enables easy scanning of barcodes on high shelves or other hard-to-reach areas
- **Fast** - Rapidly decodes all 1D and stacked barcodes (including ISBN book and VIN numbers), even worn, damaged or tightly spaced codes
- **Long-Lasting Battery** - Power to last over 16 hours
- **Replaceable Battery** - 2 AA NiMH rechargeable batteries
- **User Indicators** - Improved interface with intuitive LEDs, beeps, and vibrations let users know battery status, Bluetooth connection and scanning status
- **User Feedback** - Audible tones and hand pulsation
- **Exceptional Ergonomics** - Small, lightweight and fits perfectly in the hand for comfortable use over extended periods
- **Protective Material** - Made with antimicrobial material for protection against potentially harmful bacteria
- **Color Options** - Blue, green, red, white and yellow colors enable style, corporate-branding for personalization and in easy to find in varying work environments.
- **Application Integration** - Socket Mobile's Capture SDK enables integration in your applications to improve business productivity with fast, efficient and reliable data transfer over Bluetooth wireless technology.
- **Wearable** - Includes wrist strap. Holster, lanyard and retractable clip available (sold separately)
- **Designed and Assembled in the USA**
- **Developer Support Available**
- **1-Year Warranty**



## Status Indicators

- Beep
- Vibrate

## Intuitive LED Indicators

- Battery LED: Green, Amber & Red
- Bluetooth LED: Blue
- Scan LED: Green and Red

## Weight/Mass

- 4.0 oz. (113 g)

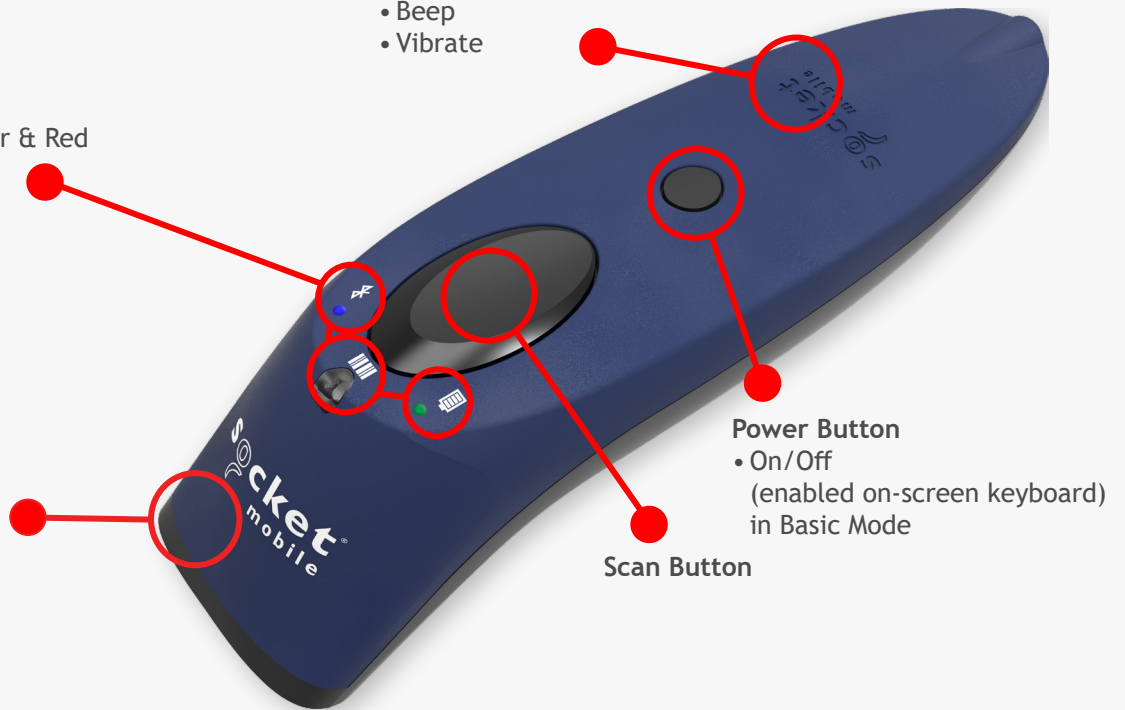

- (1) SocketScan S730, Class 2 Laser Barcode Scanner
- (1) Charging Cable
- (1) Wrist Strap
- (1) Get Started insert

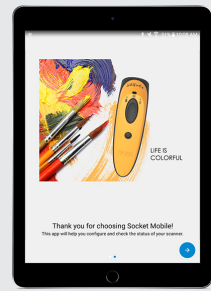

Socket Mobile Companion  
Download for Free!

The S730 is available in 5 colors:

Blue (SKU# CX3361-1683)  
Green (SKU# CX3404-1862)  
Red (SKU# CX3400-1858)  
Yellow (SKU# CX3402-1860)  
White (SKU# CX3406-1864)

## OPTIONAL ACCESSORIES

Charging Stand  
SKU# AC4076-1538



Great for using AutoScan Mode

Charging Dock  
SKU# AC4133-1871



Ideal as a desktop charger

Durable Retractable Clip  
AC4130-1828



Provides quick access to scanner

Holster  
AC4131-1829



Safe and accessible placement

Lanyard - Black  
AC4100-1692



Great for hanging around your neck

## WARRANTY

Scanner:	Standard one year limited warranty
Accessories:	90 days
Extended Warranty: (sold separately)	<a href="http://www.socketmobile.com/socketcare">www.socketmobile.com/socketcare</a>



# SCANNING PERFORMANCE

Default Barcode Symbologies	Australia Post, Code 39, Code 128, EAN-8/JAN, Ean-13/JAN, GS1 Databar Expanded, GS1 DataBar Limited, GS1-128, Interleaved 2 of 5, ISBT 128, UPC A, UPC E0
Supported Barcode Symbologies:	Australia Post, Bookland EAN, Chinese 2 of 5, Codabar, Code 11, Code 39, Code 93, Code 128, EAN-8/JAN, Ean-13/JAN, GS1 DataBar, GS1 Databar Expanded, GS1 DataBar Limited, GS1-128, Interleaved 2 of 5, ISBT 128, Korean 3 of 5, Matrix 2 of 5, MSI, UPC A, UPC E0
Scan Angle:	Wide: 47° (Default)    Medium: 35°    Narrow: 10°
Optical Resolution:	0.005 in. Minimum element width
Print Contrast:	Minimum 25% absolute dark
Reading Distance:	<p>1D codes 3.05 to 457.2 cm (1.2 in to 180 in) Depends on width &amp; barcode size, symbology, label media, Narrow and Wide ratio scan angle</p>

## BATTERY

Battery:	2 AA NiMH rechargeable batteries
Charge Time:	~6 Hours
Battery Life - Per Full Charge:	Standby time: over 20 hours Active Scan Time: 100,000 scans within 9 hours (based on 2 scans every 1 second) 16,000 scans within 18 hours (based on 1 scan every 4 seconds)
Note:	Battery life varies depending on ambient temperature, ambient light and age of battery.

## SCANNER TYPE

Technology:	1D Class 2 Laser Barcode Scanner
Laser Power at 650 nm :	Scanning Mode: 1.7 mW (nominal peak power) Aiming Mode: 0.67 mW

## BLUETOOTH (WIRELESS CONNECTION)

Bluetooth Radio:	Class 2 Bluetooth, version 2.1 + EDR (Enhanced Data Rates) with 56-bit data encryption
Bluetooth Range:	Up to 10 m (33 ft.) depending on environment, range limit is usually due to the Host Device (phone, tablet or notebook)
Bluetooth Profiles:	Basic Mode - Human Interface Device (HID)*, Application Mode - Serial Port Profile (SPP) and Application Mode - MFi-SPP. Some Operating Systems or smartphone/tablet models may support only one profile. <i>*By default, the scanner is set to Basic Mode (HID).</i>



Ambient Light:	From 4,800 to 86,000 lux From artificial indoor (fluorescent & incandescent) to natural outdoor lighting (direct sunlight)
Operating Temperature:	-20° to 50° C (-4° to 122° F)
Storage Temperature:	-40° to 70° C (-40° to 158° F)
Relative Humidity:	95% at 60° C (140° F) (non-condensing)
Drop Specifications:	4 ft. drop to linoleum

## OPERATING SYSTEM COMPATIBILITY

Android OS - Basic Mode (HID)* & Application Mode (SPP)	Mac OS - Basic Mode (HID)* only
Apple iOS - Basic Mode (HID)* & Application Mode (MFi-SPP)	Windows OS - 10, 8, and 7 - Basic Mode (HID)* & Application Mode (SPP)
Compatible with devices supporting Basic Mode (HID)* protocol	Windows Mobile, Embedded Handheld - Basic Mode (HID)* & Application Mode (SPP)
<i>*By default the scanner is in Basic Mode (HID). No software installation required.</i>	

Certified by Apple® for iOS devices (iPad®, iPhone®, iPod Touch®) and compatible with Android and Windows®.

iOS



OS X



## CERTIFICATION & REGULATORY

Bluetooth SIG:	Declaration ID: D030473    QD ID: 82009
Electrical Safety:	Certified to IEC 60950-1, UL 60950-1, CAN/CSA C22.2
Environmental:	Environmental: RoHS EN 50581
EMI / RFI:	FCC Part 15 Class C, RSS 210, iCES 003, C-Tick, CISPR 22, CE EN55022, EN55024, TELEC FCC ID: T9J-RN42 IC ID: 6514-RN42 Telec:  201-125799
LED Safety:	IEC/EN 62471 (EXEMPT GROUP)



SRRC



## COMMON USES

Retail/Point of Sale	Warehouse Inventory management
Asset Tracking	Shipping & Receiving
Healthcare	Field Sales/Service
Mobile Tracking	Supply Chain / Proof of Delivery
Field Sales Merchandising & Account Management	Hospitality

socketmobile.com

Toll-Free: +1 800 552 3300 (USA/Canada)

France: +33 970 462 241

Latin America: +1 510 933 3153

sales@socketmobile.com

Asia Pacific: +1 510 933 3122

Germany: +49 9401 5299 052

Switzerland: +41 62 834 07 80

EMEA & Russia: +41 62 834 0780

Japan: +8190 9808 0518

UK/Ireland/South Africa: +44 (0) 1252 761403  
+44 7787 112109